

# VILLAGE OF SPRING GROVE ZONING MAP

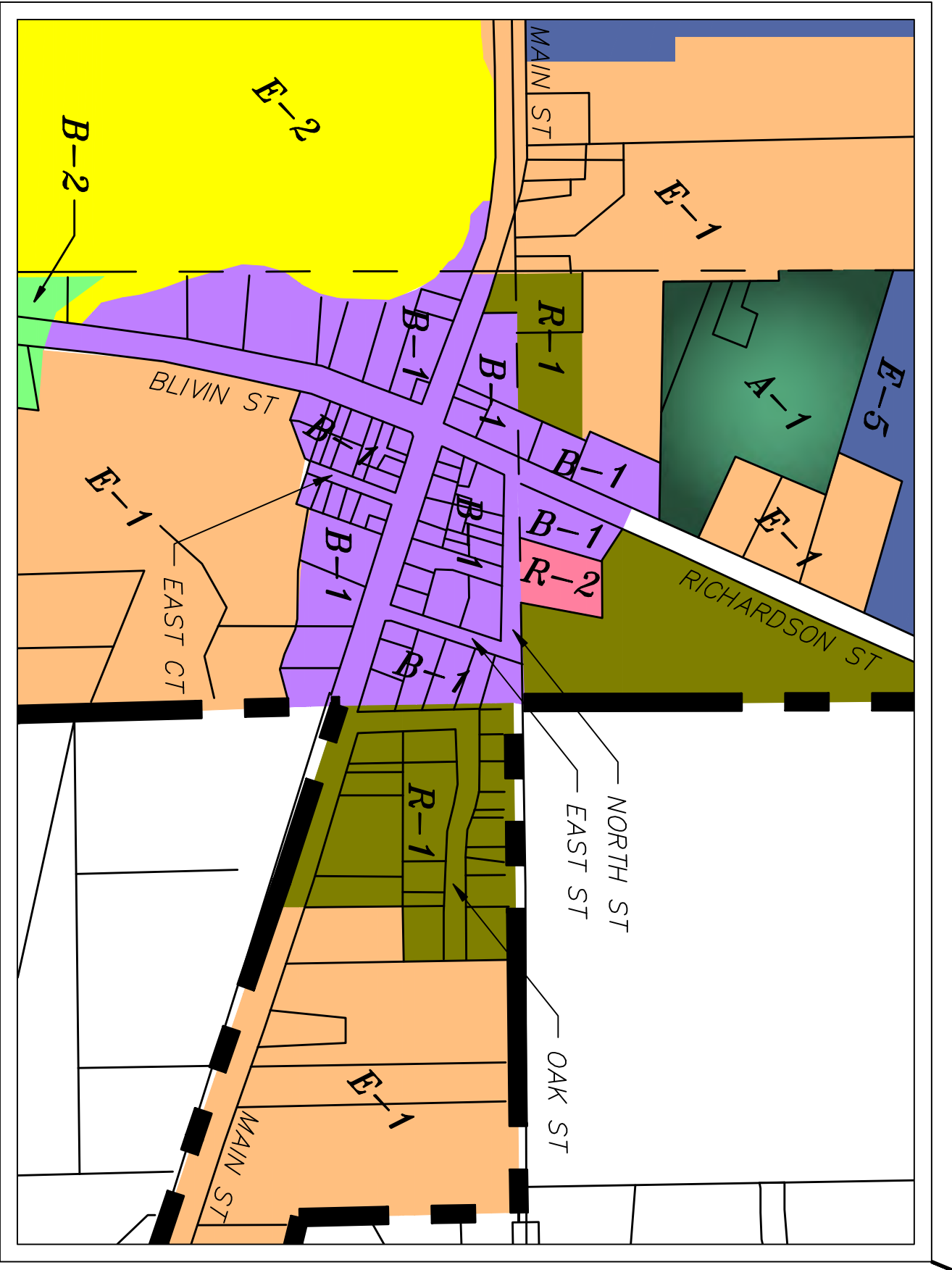
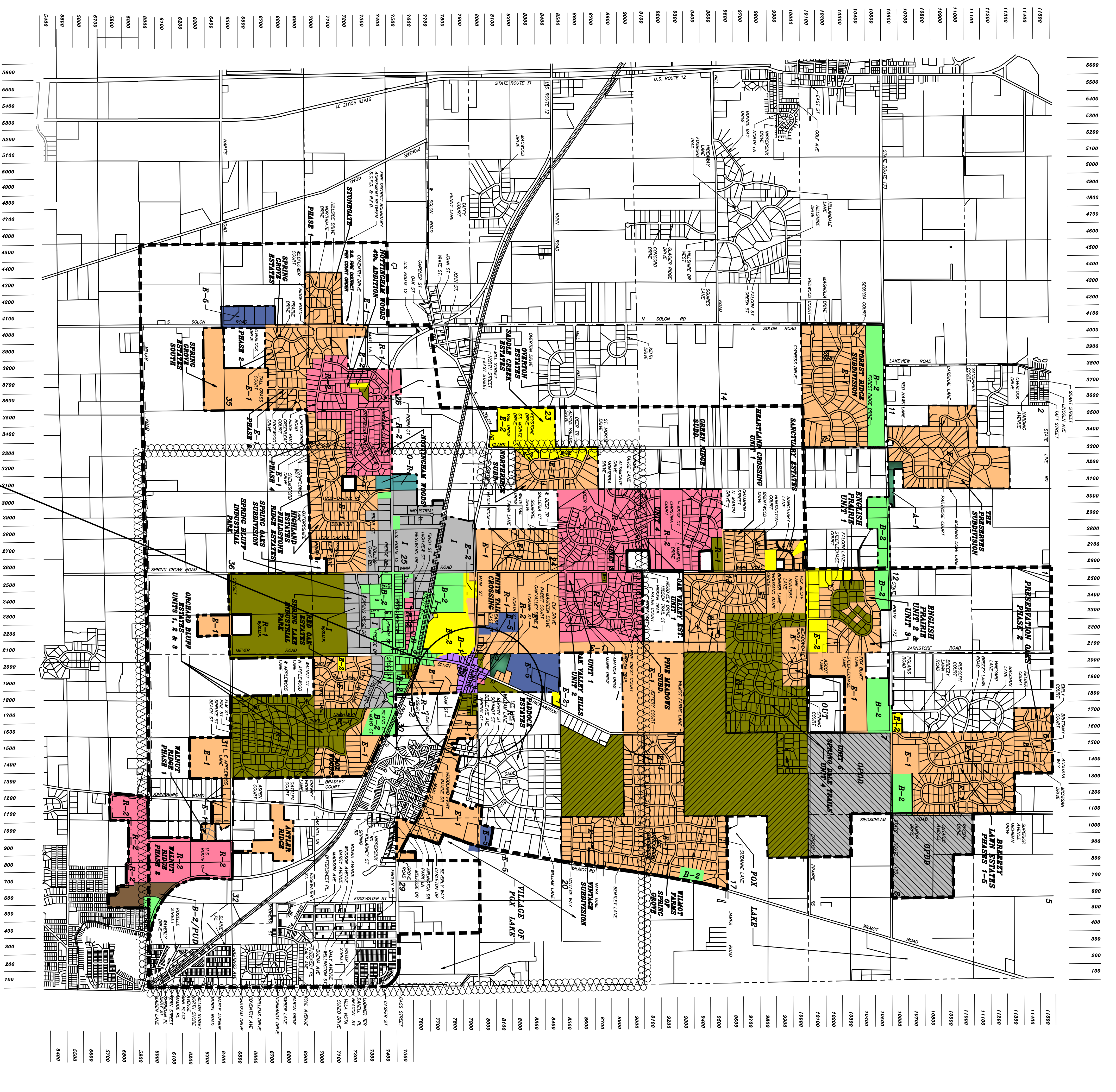

DETAIL A  
SCALE 1"=60'

**ZONING DISTRICTS:**

- A-1 AGRICULTURE
- B-1 CENTRAL BUSINESS
- B-2 GENERAL BUSINESS
- E-1 ESTATE RESIDENTIAL 1 ACRE MINIMUM
- E-2 ESTATE RESIDENTIAL 2 ACRE MINIMUM
- E-5 ESTATE RESIDENTIAL 5 ACRE MINIMUM
- I INDUSTRIAL
- O-R OFFICE / RESEARCH
- R-1 SINGLE FAMILY RESIDENTIAL 40,000 SF MINIMUM
- R-2 SINGLE FAMILY RESIDENTIAL 30,000 SF MINIMUM
- PUD PLANNED UNIT DEVELOPMENT
- OPD OVERLY PLANNED DEVELOPMENT DISTRICT - INDUSTRIAL
- ADD APARTMENT OVERLAY DISTRICT - RI

**LEGEND**

- FINE DISTRICT LINE
- MUNICIPAL BOUNDARY LINE
- BOUNDARY ADJACENT LINE
- SCHOOL DISTRICT LINE
- SECTION LINE

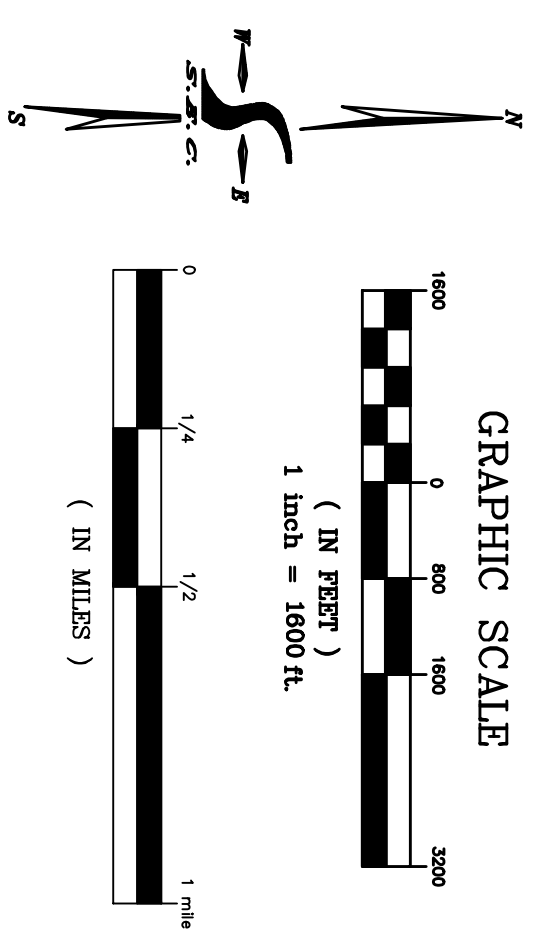

<b>VILLAGE OF SPRING GROVE ZONING MAP</b>			
REVISIONS	DATE	PROJECT NO.	
1. W/P 9-2-2008	02-18-08	SPR-080017-7	
2. DSN BY: INT	HORIZ SCALE:	SHEET NO.	
3. W/P	1" = 1000'	1	
4. CHK BY: INT	VERT SCALE:		
5. SPR			

**SMITH ENGINEERING CONSULTANTS, INC.**  
CIVIL/STRUCTURAL ENGINEERS AND SURVEYORS  
P.O. Box 11400, Huntley, Illinois 60142  
www.smithengineering.com  
PH: 847-942-8800 FAX: 847-942-1483  
E-MAIL: es@smithengineering.com

DESIGNED BY: ROBERT J. SMITH  
ILLINOIS PROFESSIONAL DESIGN FIRM # 184-000108  
VIEW: 24X38

COMP. FILE: V08-zoning-map.dwg  
PLOT FILE STANDARD